

MVSN-220 series

NAMUR SOLENOID VALVE



mindman

(Explosion - proof type)

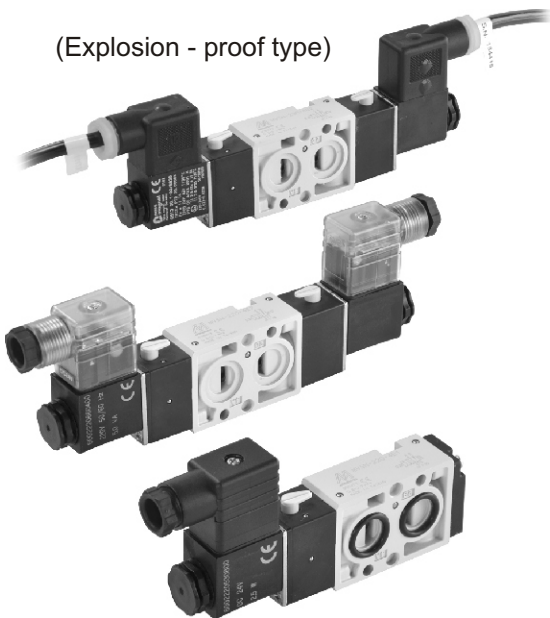

Specification

| Model | 4E1 | 4E2 |
|----------------------------|-------------------------------------|---------------|
| Bore No. | 6A, 8A | |
| Port size | G1/8, G1/4 | |
| No. of port | 5 | |
| No. of position | 2 | |
| Medium | Air | |
| Operating pressure range | 0.2~0.7 MPa | |
| Proof pressure | 1 MPa | |
| Effective orifice | 18 mm ² | |
| Response time | 38 ms | |
| Ambient temperature | -5~ +50°C (No freezing) | |
| Voltage | AC110V, AC220V (50/60)Hz, AC/DC 24V | |
| Power consumption | AC=6/4.9VA, DC=2.5W | |
| Available voltage range | ± 10% | |
| Insulation class | F class | |
| Weight (Explosion - proof) | 233 g (441 g) | 343 g (761 g) |

Order example

MVSN - 220 - 4E2 - 8A - AC110 - L

MODEL

BODY WIDTH

BORE SIZE

6A : G1/8
8A : G1/4

VOLTAGE

AC220V(50/60)Hz
AC110V(50/60)Hz
DC24V

Blank: DIN connector
L: DIN connector with LED indicator
E: Explosion protection (Table 1)
W: Lead wire

4: 4way

E1: Single Solenoid
E2: Double Solenoid

Flow features

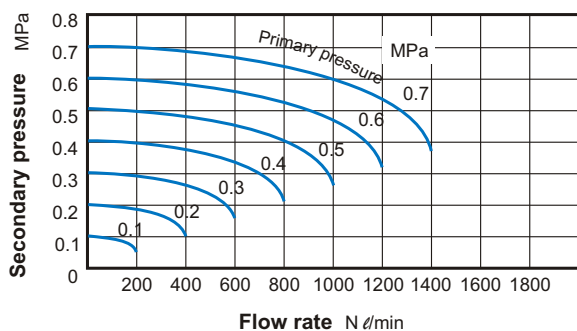

Table 1

Property for explosion-proof type

| | |
|-------------------------|---------------------------------|
| Anti-explosion class | EEx m II T4 |
| Voltage | AC110V, 220V, (50/60)Hz, DC24V. |
| Power consumption | AC=4.4VA DC=5W |
| Available voltage range | ± 10% |
| Insulation class | F class |



mindman

MVSN-220 Dimensions

NAMUR SOLENOID VALVE



mindman

MVSN-220-4E1

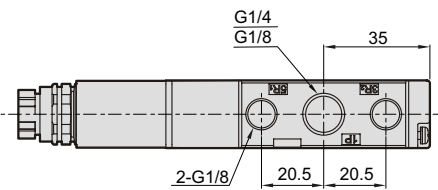
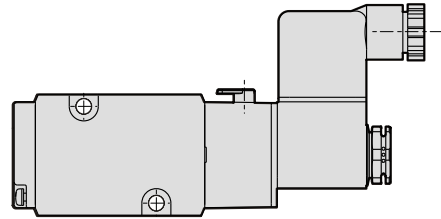
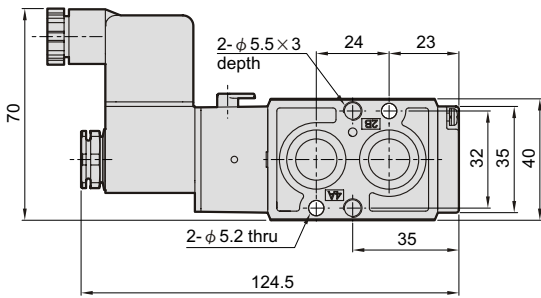
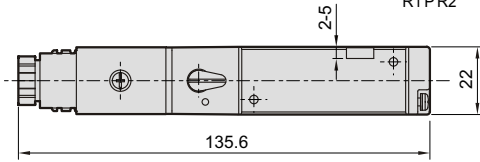
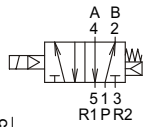

MVSN-220-4E2

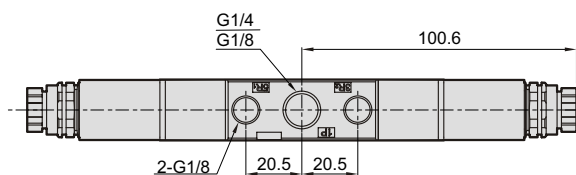
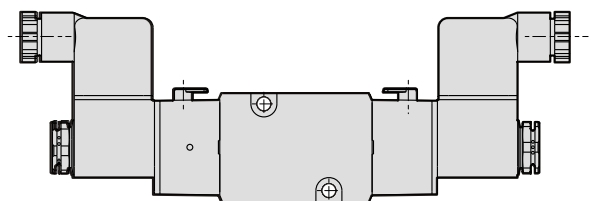
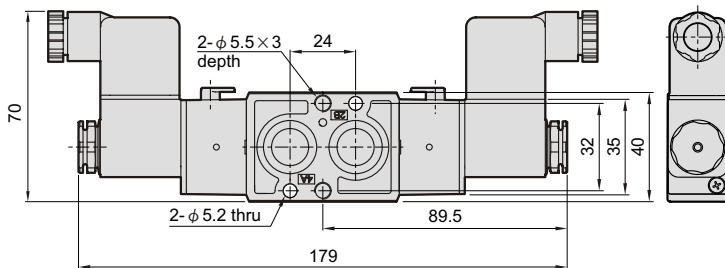
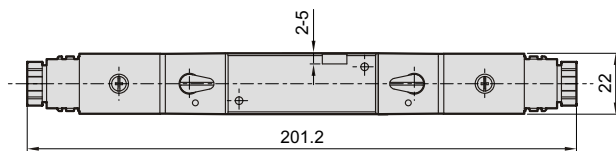
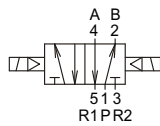

mindman